

# NxGen Peak Flow Meter Setup Instructions

## Step 01 Insert Batteries

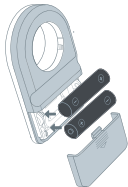

Open battery latch and insert AAA batteries. Close the latch securely until it clicks.

## Step 02 Insert Turbine

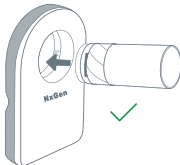

Insert the Safety Turbine from the front, as shown in the figure.

## Step 03 Fit the Turbine in the Device

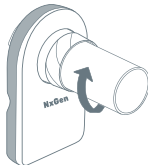

Gently push and rotate the Turbine in Clockwise direction until it is fully fitted.

## Step 04 Download the App



Scan to  
Download the  
App



## Step 05 Setup Profile

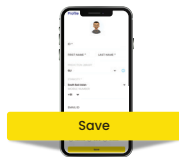

Tap "Continue" to Set  
Up Profile

Visit : [www.nxgenhealthsolutions.com/usermanuals](http://www.nxgenhealthsolutions.com/usermanuals) to download the user manuals.

**Step 06** Allow Location Access

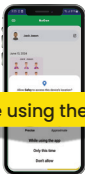

While using the app

Allow for Location Access

**Step 07** Battery Status



Start Test

Check Battery, then Tap "Start Test"

**Step 08** Test Procedure



Stand, hold the device, and exhale forcefully

**Step 09** View Results and Finish Test



Finish Test

View Results and Tap "Finish Test"

**Step 10** Generate and View Report



Share Report Print Report

View the Report and Tap "Share Report" to share the report.

**SCAN HERE  
TO DOWNLOAD  
USER MANUALS**

