

# NxGen Peak Flow Meter Setup Instructions

## Step 01 Insert Batteries

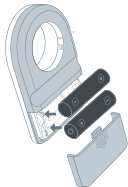

Open battery latch and insert AAA batteries. Close the latch securely until it clicks.

## Step 02 Insert Turbine

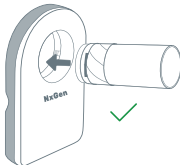

Insert the Safety Turbine from the front, as shown in the figure.

## Step 03 Fit the Turbine in the Device

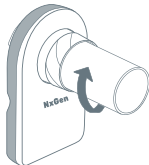

Gently push and rotate the Turbine in Clockwise direction until it is fully fitted.

## Step 04 Download the App



Scan to Download the App

## Step 05 Setup Profile

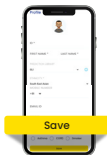

Tap "Continue" to Set Up Profile

## Step 06 Allow Location Access



Allow for Location Access

Log on to : [www.nxgenhealthsolutions.com/usermanuals](http://www.nxgenhealthsolutions.com/usermanuals) to download the user manuals.

**Step 07** Battery Status



Check Battery, then Tap  
"Start Test"

**Step 08** Take test and  
view results



Stand, hold the device,  
and exhale forcefully

**Step 09** View Results  
and Finish Test



View Graph and Results,  
then Tap "Finish"

**Step 10** Generate and  
View Report



Choose the test and  
Tap to View Report

**Step 11** Share Report



Tap to share your report  
via WhatsApp, Email, or  
Cloud Storage.

**SCAN HERE  
TO DOWNLOAD  
USER MANUALS**

